



pinedale 16

HOUSE & LAND \$632,990



— AUSTRAL —
OLIVE GROVE

4 2 1

Total area* 148.6m²
Block size 301.9m²

Lot 8
Austral NSW 2179

PACKAGE FEATURES:

- Urban Series specifications & inclusions
- Basix report inclusive of rainwater tank
- Quality laminate flooring throughout
- Quality carpet to bedrooms
- Stainless steel appliances
- Stainless steel 900mm rangehood
- Triple coated paint system
- 90mm wall frames
- Colour concrete driveway & path

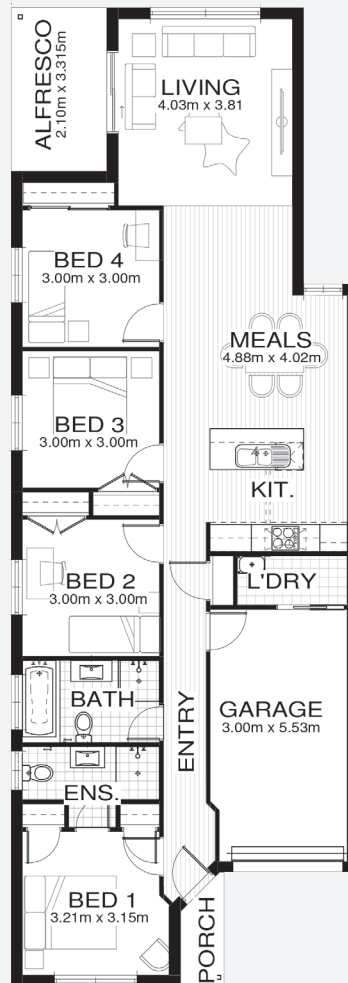

olivegroveaustral.com.au



*Includes garage, alfresco, porch & eaves. *Images are for illustrative purposes only and may include options not included in price. Please talk to a Bellriver consultant for a full list of inclusions. Package price is based on September 2018 pricelist. Bellriver Homes reserves the right to change specifications & prices without notice. V79684