

# HOUSE & LAND PACKAGES

**\$1000 DEPOSIT**  
Secure your package today



## SEAFORTH 254

4 2 2

# \$638,265

**THE URBAN PROJECT**  
AFFORDABLE HOMES

**Lot 530, Johannes Street  
St. Helena's Estate  
Lochnivar, NSW 2321**

**House size<sup>†</sup> 253.4m<sup>2</sup>  
House price \$368,265**

**Land size 900.0m<sup>2</sup>  
Land price \$270,000**

### Bellriver Urban packages feature:

- Urban Series specifications & inclusions
- Basix report inclusive of rainwater tank
- Site costs & service connections
- Quality laminate flooring throughout
- Quality carpet to balance
- Westinghouse S/S appliances
- Westinghouse S/S 900mm rangehood
- Triple coated paint system
- 90mm wall frames
- Plain concrete to porch & alfresco

### This package also includes:

- Lennox façade
- Concrete driveway & path
- 20mm stone kitchen benchtop
- Automatic roller door
- Ducted A/C



### Contact:

Steve Briant - 0450 828 981  
steve.briant@bellriverhomes.com.au

[bellriverhomes.com.au](http://bellriverhomes.com.au)



\*Includes garage, alfresco & porch where included. †Images are for illustrative purposes only and may include options not included in price. Please talk to a Bellriver consultant for a full list of inclusions. Package price is based on July 2020 pricelist. Bellriver Homes reserves the right to change specifications & prices without notice.

# PROPOSED SITING OF YOUR NEW BELLRIVER HOME

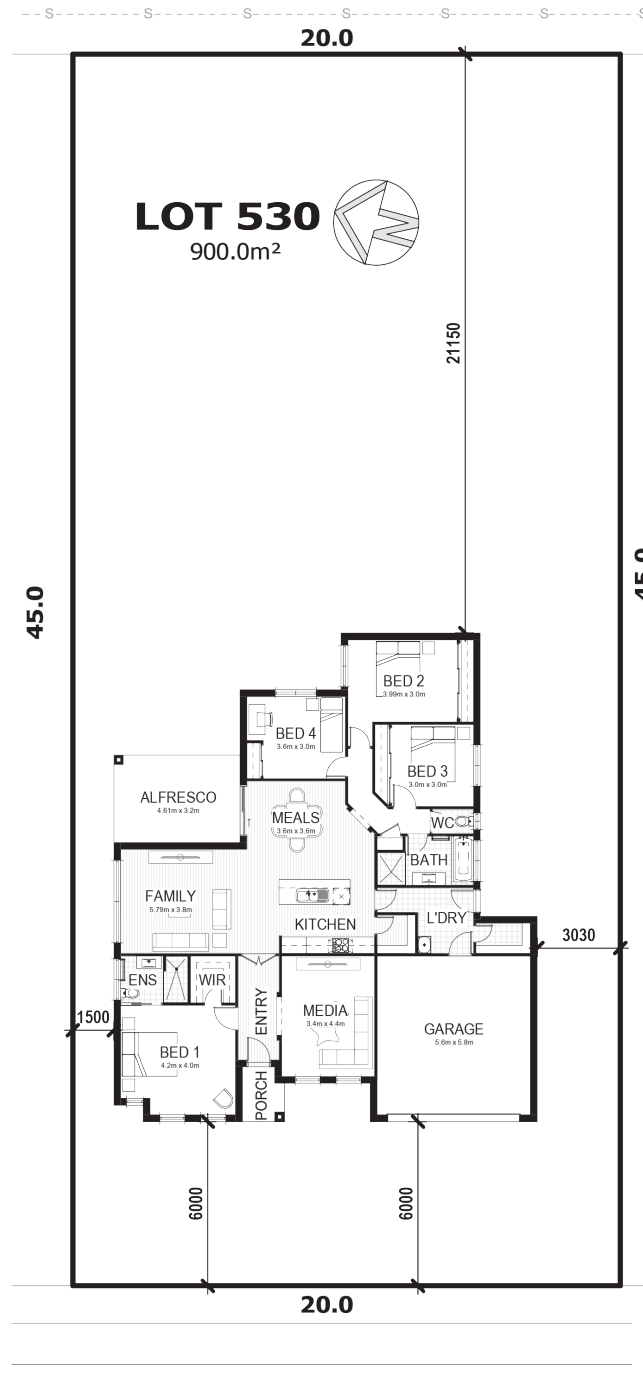

## JOHANNES STREET

### SIMPLIFIED CDC

**Note:** This is a preliminary siting and is subject to a clear copy of title and approval of the builder.

This siting is subject to developer approval, rescod (state building regulations) and council requirements (if required).

### Land siting acceptance:

Sign 1:

Sign 2:

Date:

[bellriverhomes.com.au](http://bellriverhomes.com.au)

